

SUNLITE

BICYCLE TRAILER



OWNER'S ASSEMBLY AND **SAFETY MANUAL**

User Instructions

- Main Frame Assembly
- Installing the Wheels
- Parking the Trailer
- Installing Crossbar and Attaching the Seat
- Using the Five Point Harness
- Attaching the All-Season Top Cover
- Attaching Reflectors and lights (optional)
- Attaching the Flag
- Hitch Arm Assembly
- Attaching Trailer to Bicycle

**PLEASE READ ALL INSTRUCTIONS AND WARNINGS,
AND EXAMINE THE CONTENTS CAREFULLY
BEFORE ASSEMBLY!!!**

USER INSTRUCTIONS

NOTE: Biking and bicycle touring are increasingly popular recreational activities. Your new trailer is designed and constructed to provide a portable, comfortable and sturdy addition to your outdoor ventures. **PLEASE READ THE INSTRUCTION MANUAL AND ALL SAFETY WARNINGS CAREFULLY BEFORE USING YOUR TRAILER.**

IMPORTANT

PASSENGERS AND RIDERS SHOULD ALWAYS WEAR PROPERLY FITTING, APPROVED CYCLING HELMETS

KEY FEATURES OF THE TRAILER

- Quick assembly, take-down and storage
- Forward-facing two passenger seating
- Padded steel seat for comfortable seating (not falling or leaning on each other)
- Five-point seating harness with quick lock and release
- Snug full cover top with roll-up window
- Push button quick release removable wheels

WARNING

- Not for use with infants under 18 months of age.
- Children must be able to hold up head with a helmet on.
- Children must always use seat and bike helmets.
- Never leave children unattended.
- Always ride defensively.
- Do not exceed 88lbs (40kgs) maximum load.
- Do not exceed 10MPH (16km/h) maximum speed.
- Always instruct children NOT TO rock, bounce, or lean.
- Ventilate during hot weather.

PRE-RIDE SAFETY CHECK

- Check to ensure hitch clamp is tight.
- Check to ensure hitch safety strap is secure.
- BUCKLE UP! Check seat harness and secure all baggage.
- Inspect bike and trailer condition before each use.
- HELMETS ON! Ensure rider and child helmets are on and secure.
- Check TIRE AIR PRESSURE. Always maintain between 25 and 30 PSI (1.70 and 2.00 BAR).

RIDING TIPS

- Ride slower than you would if you were without the trailer.
- You will require extra stopping distance. Use your brakes early.
- Take corners very gradually.
- Use on smooth roads only. Do not ride over curbs, potholes, or off road.
- Always use the flag supplied with the trailer to allow others to see you.
- Avoid riding at night.

SAFETY GUIDELINES

THINK SAFETY FIRST. Check the working conditions of both the bike and trailer before each use. If you discover broken components, misalignments or missing parts, correct the problem prior to use. Please refer to all warning and guidelines for the proper use of the trailer. Be aware of what is necessary to safely control the bike-trailer combination.

PLEASE FOLLOW THESE SAFETY GUIDELINES WHEN USING YOUR TRAILER:

- Inspect the trailer and its parts before and after each use. Proper care and maintenance of the trailer are essential for safety
- When assembling the trailer, make sure the wheels are correctly and securely installed as described in the assembly instructions. Inflate the tires to 30 PSI and check the pressure before each use. Over-inflation may cause the trailer to bounce or turn over. Use only tires with street tread and not with BMX or knobby tread.
- Attach the hitch clamp securely to the bicycle frame at the chainstay. The clamp tightening knob should be tight and the safety strap wrapped around the chainstay and hooked buckle to the D-ring
- Be sure that the bicycle used with the trailer is in good working condition and has good brakes. A bicycle shop can help you with inspection and maintenance.
- Do not overload the trailer. The load limit for cargo and/or passengers is 88lbs (40 kgs). Position the load as low as possible and center it within the trailer (front to rear and left to right). Any extra gear should be placed towards the rear. All loads should be secured so that it does not shift. **IMPORTANT:** Instruct children riding in the trailer not to bounce, rock, or lean; such movements may cause the trailer to lean or flip.
- Do not attempt to install other seating systems in the trailer. It is not designed for car seats, stroller seats, infant beds, or any other type of seating. Use of any seating system other than the original equipment seat will void the warranty, and may result in damage to the trailer or injury of the passengers.
- Pulling this trailer after the operation of the bicycle: Stopping, starting and turning are affected, depending on the weight of the cargo. To familiarize yourself with the changes, load the trailer to capacity and practice in a safe area. Do not use your trailer until you have become accustomed to how it affects your bicycle handling.

SAFETY TIPS FOR RIDING

- Never assume you will be given the right-of-way.
- Do not try to predict the actions of car drivers.
- Do not travel on the highway, busy streets or in areas unsafe for bicycling.
- Avoid riding at night unless you use lights and bright reflective clothing. Do not ride at night with children in the trailer.
- To prevent overturning your trailer, do not pull it over curbs or holes or hit obstructions on the road.
- Do not turn sharply, because the trailer may turn over.
- Do not travel or descend at high speeds.
- Do not exceed 10MPH (16 km/h), because high speeds adversely affect your ability to control the bike and to notice road irregularities.

SAFETY RECOMMENDATIONS* *FOR PASSENGERS

The safety of your child is of great concern. The trailer seat is intended for passengers older than 18 months and able to wear an approved helmet. Your children must be able to hold their heads upright. Check with your pediatrician to make sure your child's development makes him or her suitable passenger in this trailer.

Make sure that your child is seated securely and the harness is properly engages. The child's seated height should be below the crossbar, and the correct shoulder strap height must be used. Refer to the assembly instruction and diagram. Make sure your child cannot touch the moving wheels or the roadway.

MAIN FRAME AND SIDE PANEL ASSEMBLY

Remove trailer and all components from carton. While trailer is still in folded position, lift both side panels to upright position. Insert the safety pin into the plastic catch at the bottom of the rear side panel to set up the side panels. (Refer to diagrams)



INSTALLING WHEELS

Place the wheel hub on the axle by simply pushing in the wheel until it snaps in place, so the wheel cannot be removed. Push in all the way so that the wheel cannot be pushed further. After both wheels are assembled/attached pull on the wheels to ensure they cannot be removed. To remove the wheels, lift back of trailer up and simply push on the push buttons located on the axle and remove the wheel.

NOTE: Check tire sidewall for proper tire inflation & check tires regularly.



WARNING

Failure to properly adjust wheels with quick release levers could allow wheel to come off during use. This could lead to serious injury.

INSTALLING WHEEL GUARDS

Insert the safety wheel guard by pressing the release pin in the tubing into the base frame (the tubing assembly fits into the plastic catches on the frame) and secure the release pins through the holes provided.

NOTE: Make sure the release pin goes through the hole in the frame and the wheel guards assembly.



PARKING THE TRAILER

Some models are equipped with a parking strap to secure the wheel and prevent the trailer from rolling while parked. Caution should be used when parking a trailer with or without a parking strap, especially when parking on a hill or uneven terrain. The trailer may be able to rotate even when a parking strap is used as only one wheel is secured.

To park the trailer equipped with a parking strap, use the parking strap fastened on the right side of the back guard. Wrap the strap around the wheel rim and snap the hook on the pin.

To run the trailer, hang up the braking strap hook on the pin, and avoid the clip at the end of the trailer that cannot reach the wheels. Be sure to properly secure the strap when not in use to avoid it dragging or becoming entangled.

INSTALLING CROSSBAR AND SEAT

Install crossbar with fabric seat (at the top of the side panels) by inserting one end into one of the plastic crossbar catch on top of the side panel(see instructions). Be sure to line up the holes in the crossbar with the holes in the catch to allow the safety pin to be installed. Insert safety pin that is on the strap attached to the side panel. Lock safety pin as shown in the images illustrations below.

NOTE: Ensure that the safety pin is secured with the wrap spring clip.

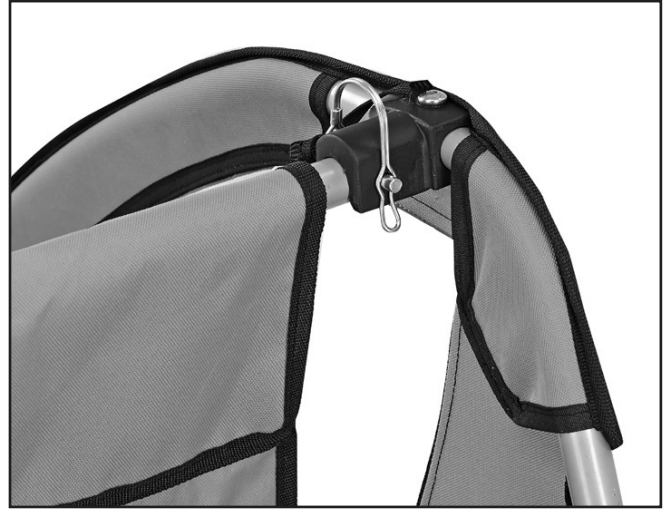

USING THE FIVE POINT SEAT HARNESS

The harness system in your Foldable Trailer is designed to keep your passengers immobilized and secure during transport. The harness is designed to accommodate one or two children.

- Disconnect shoulder strap clips from crotch strap D-ring
- Place child in seat. If carrying a single passenger, place child in the middle of the trailer seat.
- Put one strap over each shoulder and connect to the D-ring of the crotch strap
- Adjust shoulder and crotch straps to be snug and secure
- Fasten lap belt and tighten securely

Never ride without securing passengers in the Five Point harness. Unrestrained passengers can affect bike handling; and they may be more likely to be injured in the event of an accident.

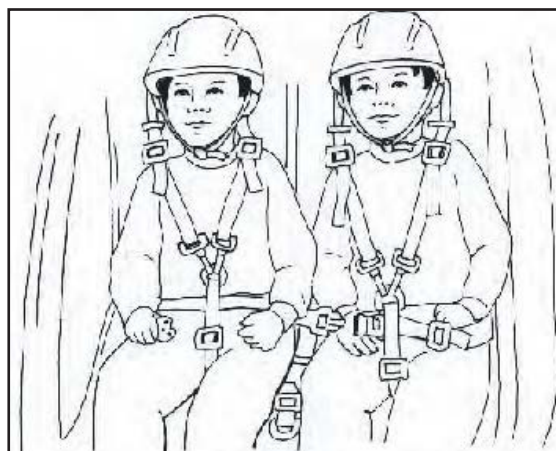

ATTACHING THE ALL-SEASON TOP COVER

Position cover over the top of the trailer so that the roll-up window with bug mesh screen is positioned over the front of the trailer.

Wrap the snap on straps on the crossbar to fix the all-season top cover on the frame.

The all-season top cover is designed to keep passengers and cargo dry and warm in inclement weather and protect from flying debris. The rain PVC cover can be rolled up to allow for added ventilation in hot weather. Velcro closures keep the rain cover out of the way when rolled up



IT IS STRONGLY RECOMMENDED THAT CHILDREN'S EYES ARE PROTECTED FROM FLYING INSECTS AND AIRBORNE PARTICLES WHEN USING TRAILER. SUITABLE PROTECTION INCLUDES: SUNGLASSES, EYEGASSES, INSECT SCREEN, OR PVC WINDOW ON ALL-SEASON TOP COVER.

WARNING

Passengers can become hot inside fully closed trailer during very hot weather or when parked. Please make sure to open the roll up top cover vents to prevent overheating.

IMPORTANT

Store trailer out of direct sunlight to prevent color fading and eventual weakening of the fabric components.

CAUTION

To protect children from flying objects, never use trailer without the front window or bug screen in place.

ATTACHING REFLECTORS AND LIGHTS

Attach the white reflectors on front of trailer, the red reflectors on rear of trailer and the amber (or white) spoke reflectors on both sides of wheels with included screws. Make certain to tighten these screws securely.

According to TUV/GS certification regulations that the battery-operated lights are essential for ensuring safety (a front light at left front trailer and a red LED light at left rear trailer).

NOTE: Additional lights and reflectors may not be included with all models.



ATTACHING THE FLAG

Insert the flagpole through the cover and into the flagpole pocket at the left rear corner of the side panel.

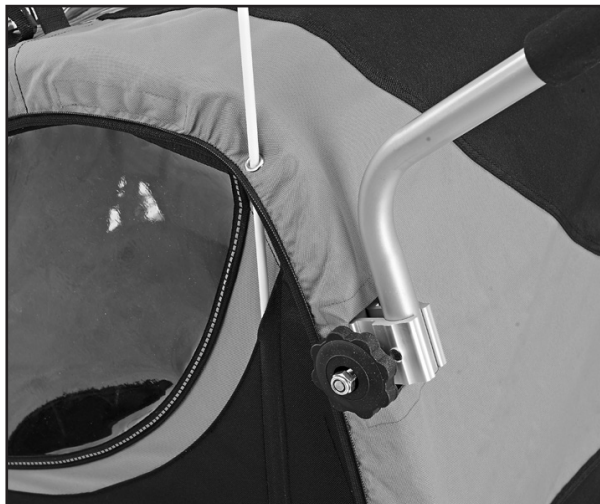

HITCH ARM ASSEMBLY

Lift front of trailer up. Remove the hitch-arm locking pin from back hole in the hitch arm bracket. Fold hitch arm out until parallel with base frame and lock the hitch arm into place by re-inserting the safety pin through the front hole of hitch arm bracket and snap the safety pin.

NOTE: Ensure the safety pin is secured with the wrap spring clip.

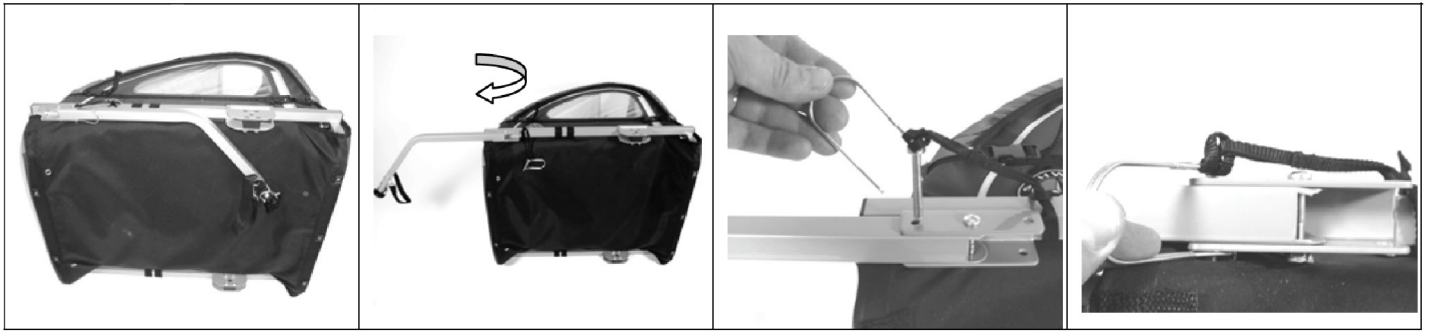

ATTACHING TRAILER TO BICYCLE

Attach the hitch to the quick release or behind the axle nut to the rear hub as indicated below. Wrap the safety strap around the chainstay of your bike, and reconnect to the D-ring located on the trailer arm. The safety strap is a back up safety device in case the hitch attachment fails or the axle nut or quick release was not secured properly and prevents the trailer from dislodging completely.



CAUTION

If the hitch interferes with your bike or other bike attachments, or if it does not tighten securely, do not use. Contact your bike dealer for help with proper installation.